

The Unytouch U15-T320UO display represents the latest in leading edge digital LCD technology. With an ultra-high resolution LCD, unparalleled image quality and configurable I/O this display is suitable for a wide range of digital signage and control-room applications. Accurate and smooth touch capability round up an impressive list of features that will make the most of your digital world.

KEY FEATURES

- **Superior Resolution**

HD 720p (1366 x 768)

- **Prolonged Backlight Life**

50,000 hours of viewing time to half of its original brightness

- **Configurable I/O**

Standard RGB and video input
Optional Audio in & Speaker out,
HD-SDi in/out

- **Durable Design**

All metal enclosure
Modular design

- **IRFM**

IRFM technology helps prevent
image retention

- **Player Mounting Space**

IPC / Player mounting space
(8.7 x 8.7 x 2.3 inch) on back panel

- **Energy Saving Control**

Active ambient light sensor that
adjusts brightness automatically

- **Optical Touch**

Precise and fast-response touch
technology

- **Multi Touch**

Compatible with Windows 7 &
multi-touch function applications

| LCD PANEL | |
|---|---|
| Brightness | 450 cd/m ² |
| Contrast Ratio | 3000:1 |
| Viewing Angle | H:176° / V:176° |
| Response Time | 6.5 ms (GTG) |
| Supported Colors | 16.7M colors |
| Resolution | 1366 x 768 (16:9) |
| SIGNAL COMPATIBILITY / CONNECTIVITY | |
| Horizontal / Vertical Frequency | 30 ~ 65 KHz / 56 ~ 75 Hz |
| Max. Input Resolution | 1366 x 768 @ 60Hz (Analog) 1366 x 768 @ 60Hz (Digital) |
| DDC | DDC 2B |
| Connector | DVI / VGA / Component / AV / S-video / Audio (optional) / HD-SDi BNC (optional) |
| Communication Port (Transport Protocol) | D-Sub 9 Pin In, RJ45 In/Out (RS232C In, RS-485 In/Out) |
| MECHANICAL | |
| Dimensions w/o Stand WxHxD | 792 x 490.7 x 127.8 mm / 31.18" x 19.32" x 5.03" |
| Weight w/o stand | Net: 23kg / 50.71 lb Gross: 28kg / 61.71 lb |
| Wall / Arm Mount Type | 200 mm x 200mm VESA |
| Fanless Design | Yes |
| OSD FUNCTIONS | |
| OSD Control | RS232C, Push Button, IR Remote Controller |
| OSD Language | English, Japanese, Chinese |
| Multimedia | PIP, PBP, Zoom |
| Source Auto Detect | Yes |
| OSD Key Lock | Yes |
| ELECTRICAL | |
| Power Supply | AC 100 V ~ 240 V (50/60 Hz) |
| Normal Operation | ≤ 120 W |
| Suspend / Standby | ≤ 12 W |
| Power Off | ≤ 6 W |
| Power Output | AC 100 V ~ 240 V (50/60 Hz), 2 A DC 12 V, 2A |
| ENVIRONMENTAL | |
| Operating Temperature | 5 °C ~ 40 °C, 85% RH |
| Storage Temperature | -20 °C ~ 60 °C, 85% RH |
| OPTICAL TOUCH PANEL | |
| Response Time | 14 ms (Typ.) |
| Interface | USB HID |
| Transmittance | 90% |
| Operating Systems | Windows 2000 / XP / Vista / 7 (Driver Required) , Mac OS, Linux |
| OPTIONS | |
| HD-SDi / SDi | In x 2, Out x 1 (BNC) |
| Audio Amplifier | Audio in & Speaker out (RCA) |
| Speaker | 5W x 2 EA, 8Ω / 5W+5W (rms) @ THD<1% |
| Other | Stand, Back Cover (I/O cover, R cover) |
| DIMENSIONS | |

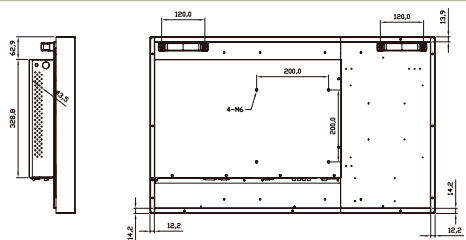
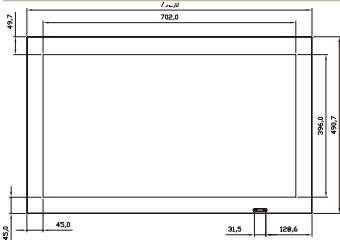

INTERFACE

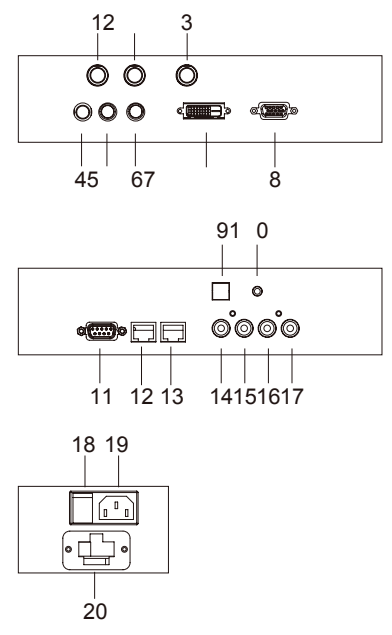

| | |
|----------|-----------------|
| 1. | SDI In 1 |
| 2. | SDI In 2 |
| 3. | SDI Out |
| 4. | Video |
| 5. | S-Video |
| 6. | YPbPr |
| 7. | DVI |
| 8. | VGA |
| 9. | Touch USB |
| 10. | Calibration |
| 11. | RS232 In |
| 12. | RS485 In |
| 13. | RS485 Out |
| 14 - 17. | Audio In / Out |
| 18. | Power Switch |
| 19. | AC-IN Connector |
| 20. | AC-Out |



* Optical specifications without glass.
 ** Weight and dimensions are approximate. Specifications and design are subject to change without notice. This product may be subject to export control regulations.

Legacy Technology Services

We Rent & Sell All Types Of Barcode Equipment

Call now to talk to an expert

866-271-9891

www.LegacyGlobal.com

Some brands we carry



MOTOROLA

Intermec

DATALOGIC™

Honeywell

EQUINOX
PAYMENTS



About us

- Legacy Technology Services is a leading nationwide provider of mobile computing, barcode, printers and point of sale equipment and services.
- For over a decade, thousands of clients across North America have trusted us to provide equipment from leading manufacturers backed by the services to support them.

Latest Hardware from top manufacturers

- Legacy handles virtually every major manufacturer of mobile computing, barcoding and point of sale equipment.

Expert Repair and Maintenance services

- Legacy is one of the best repair facilities in North America

Discontinued product sourcing

- They don't make it anymore? Our inventory also includes manufacturer close-outs and discontinued equipment to support our clients legacy infrastructure.

Trade-in and Disposal services

- That old equipment laying around your facility may still have some value. Legacy routinely purchases equipment from our clients around the globe.
 - Data destruction
 - Hardware disposal
 - Auditing services

Dedicated client account team

- Dedicated, highly trained account managers are here to answer all your questions and provide top notch service.

Equipment rental services

- Sometimes renting is a better solution, Legacy's huge rental inventory provides the equipment you need for temporary needs and projects.



Legacy, Inc.,
160 West Road,
Ellington, CT 06029

Toll Free: 866-271-9891
Fax: 888-522-4684